

Exceptional design features make this Victorian space cozy and inviting. Urns and swags accentuate the window casing, while ornate acanthus mouldings gracefully enhance the simple beam ceiling and fireplace mantel. The tall tambour wainscoting, typical of Victorian design, is capped with a grapevine-frieze chair rail; the same frieze also frames the arched panel door.

BEAMS

CM8810
DS1x6

CEILING DESIGN

PM8541

DOOR CASING

BB156
FR8956

WINDOW CASING

CM8810
DS1x10
CRV5063
CRV5069
CRV5048
CRV5121
FR8956

CHAIR RAIL

BB156
FR8956

BASEBOARD

PM8568
DS1x6
DS100

FIREPLACE MANTEL

Above Mantel

CM8810
MM187
FR8956
CRV5148

Mantel

CM8860
CM8810
BB156
FR8956

The fireplace mantel, decorated with scrolls and plume corners, is the focal point of this charming Victorian room, which features bold – yet feminine – ornamentation. Fluted Corinthian pilasters flank the mantel, and a custom mirror above the mantel features additional floral motifs plus a delicate scroll frieze. A cornice at the top of the windows complements the beaded moulding and rosettes at the bottom.

CROWN

PM8535
FR8923
FR8971

CHAIR RAIL

PM595
FR8940

WINDOW CASING

CM8825
DS1x6
PM8524
BB8108
PM521
CRV5068
CRV5178

DOOR CASING

BB8108
CA8338
PM8522
CRV5097

BASEBOARD

PM8568
DS1x6
DS111

MANTEL MIRROR

FR8921
CRV5058
CRV5070
CRV5068

MANTEL

CM8840
BB8122
CRV5130
CA328
CRV5148
CRV5074
CRV5046

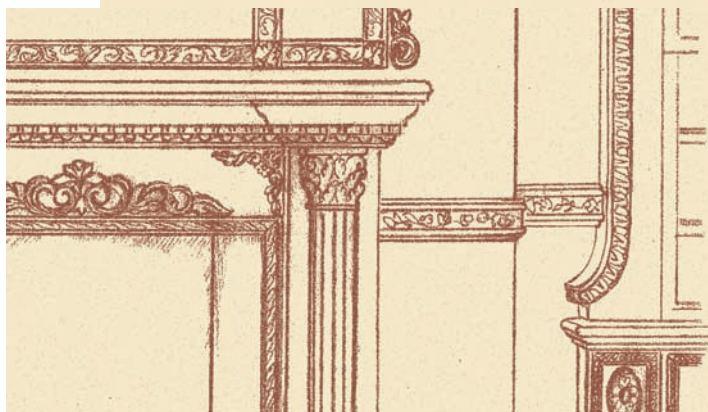
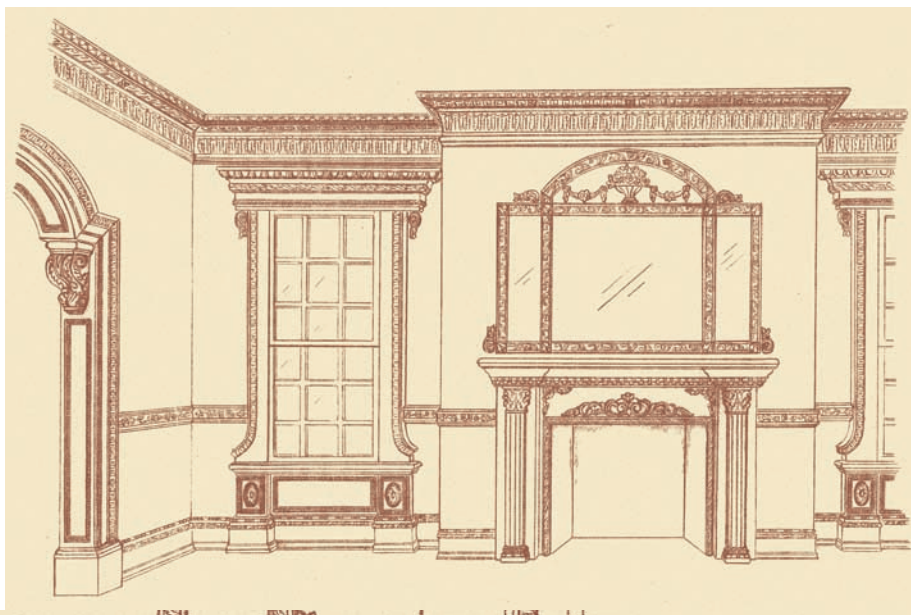

CROWN
CM8823
CO702
DE172

CHAIR RAIL
BB8108
CH650

BEAMS
CM8823
CO702
DS1x6
PM8564

BASEBOARD
B463

CEILING DESIGN
PM8523
CRV5078

WINDOW CASING
BB8108
CA300

DOOR CASING
BB8108
CA300

WALL PANELS
PM580

SHELVING
CRV5190

MANTEL
CM8820
DS1x4
PM8564
FR8971
CRV5068
PM8535

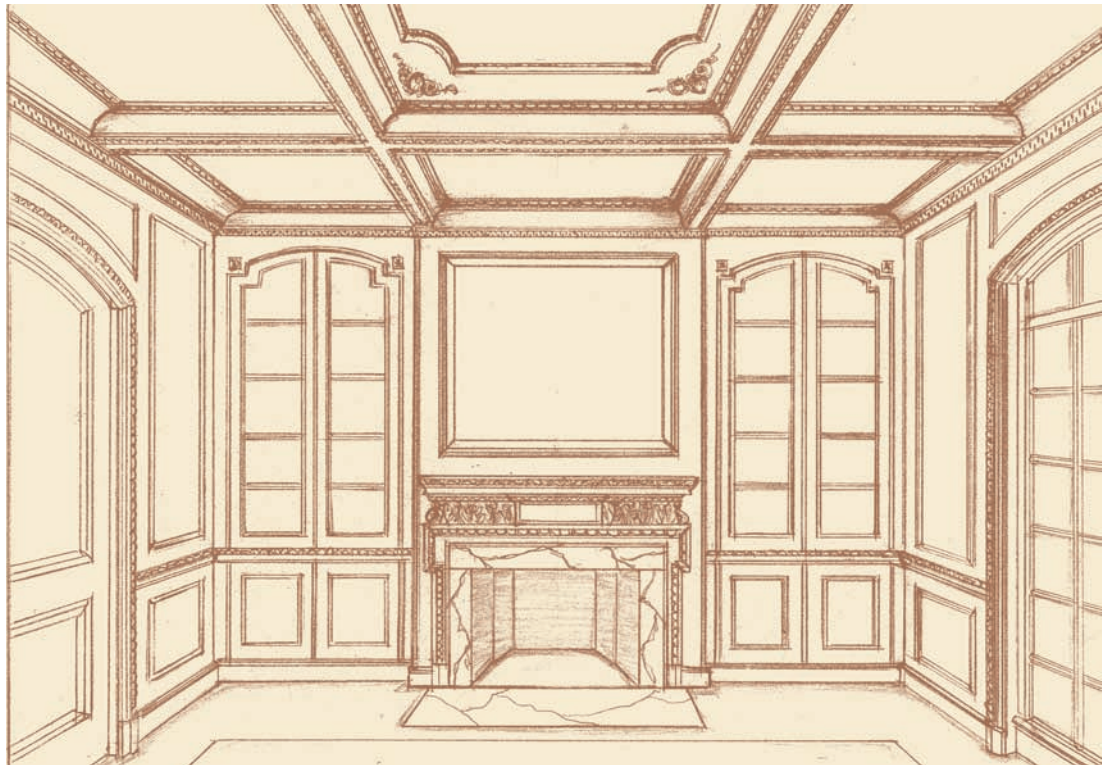

Small decorative elements such as lamb's tongue and egg and dart patterns accentuate this interior. The large acanthus leaf frieze and petite acanthus cornice draw attention to the fireplace mantel, while the smooth surrounding elements complement each other well. Authentic Hand-Carved® rosettes accent the recessed cabinetry along the wall, and large scrolled corners enhance the ceiling design.



Flower baskets, scrolls, and delicate corners dress the panels and recessed shelving of this French Formal design. The panels on the walls and the vaulted ceiling are directly applied and require no additional material. These panels include just two elements – a decorative clipped corner and a small panel mould.

BEAMS
CM8801
PM8546
FR8920

CEILING DESIGN
PM485
CRV5079

WINDOW CASING
CRV5074
FR8950
CRV5179

WALL PANELS
PM500
PM485
CRV5079

PANELS-FAR LEFT
PM8535

BASEBOARD
PM8535
DS1x8
QR105

MANTEL
Above Mantel
CRV5058
CRV5068
PM8535
CRV5079
PM485
CA344

MANTEL
CM8801
DS1x8
CRV5043
PM8541
CRV5098
CRV5149

SHELVING
CRV5058
CRV5068
CRV5074

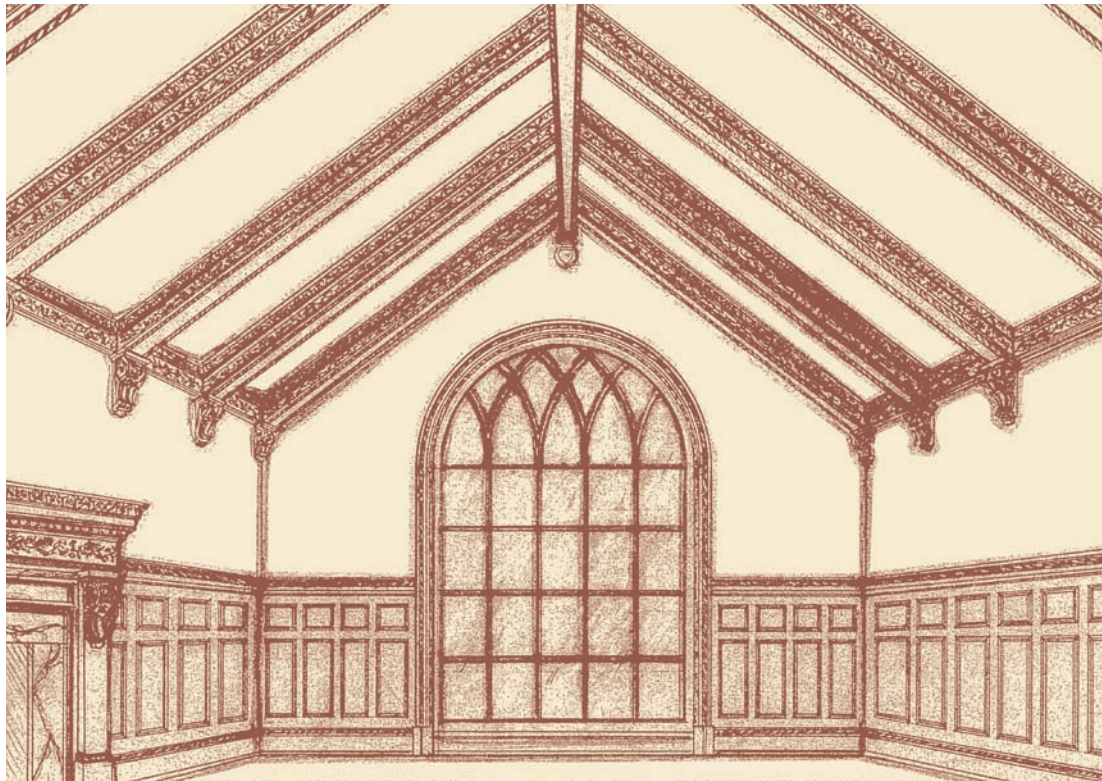

BEAMS

CM8810
FR8956
DS1x6
PM492
CRV5110

CROWN

CM8810
FR8956

WINDOW CASING

CA8320

CHAIR RAIL

PM8555
Wall Panels
Beveled Panels

BASEBOARD

PM8557
DS1x6
BS126

MANTEL

CM8810
DS1x4
CM8823
FR8956
CRV5110

This spacious room features a high vaulted ceiling adorned with beams. The beams combine an acanthus crown, a grapevine frieze, and a rope moulding and are complemented with beautiful architectural corbels. A chair rail tops off the high paneled wainscoting and fits perfectly with the tall ceiling. The English motif is carried through to the mantel, which contains the same elements as the beams.

CROWN

LCD8190

CHAIR RAIL

PM8568
DS1x2
PM8526

WALL PANELS

PM8564

BASEBOARD

PM8568
DS1x6
QR105

MANTEL

Mantel 8123

MIRROR

CM8810
CM89
BB17

PM520

PILASTERS

CRV5129
CA329
CRV5147

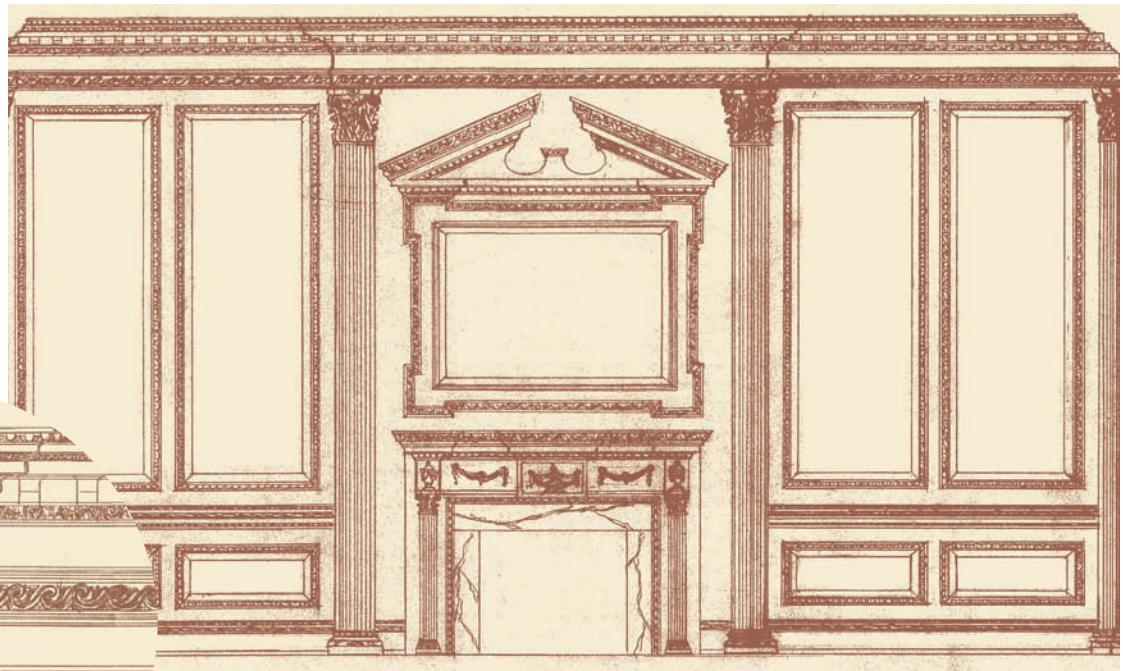

Large, Authentic Hand-Carved® Corinthian capitals and plinth blocks dress the wall of this Federal-style elevation. Smaller Corinthian capitals are placed around the fireplace mantel, along with Greek urns and floral swags. A custom panel is created just above the fireplace with a broken pediment made up of an acanthus leaf cornice and egg and dart detail. A large crown build-up finishes the room with the Vitruvian Wave frieze, modillion blocks and a dentil mould.

The focal point of this handsome room is the beautifully detailed fireplace mantel, accompanied with rich wall paneling and embellished window and door combinations. The ceiling design includes a single panel mould with a fluted medallion in the center. The fireplace mantel and door surround are consistent in design, with both featuring clipped corner panels plus an acanthus leaf frieze and a laurel swag center.

CROWN	BASEBOARD	MANTEL
CM8810	BA47	CM8820
CO702	DOOR	CDS1x4
PM8552	CASING	DS1x4
CHAIR RAIL	CM8820	PM8535
CA41	CDS1x4	FR8971
WINDOW	DS1x4	CRV5068
CASING	PM8535	CRV5072
CA40	FR8971	BB8110
CEILING	CRV5068	WALL
DESIGN	CRV5072	PANELS
MED1534	BB8120	PM525
CA335	CA8338	CRV5079
PM525		PM485
PM8552		

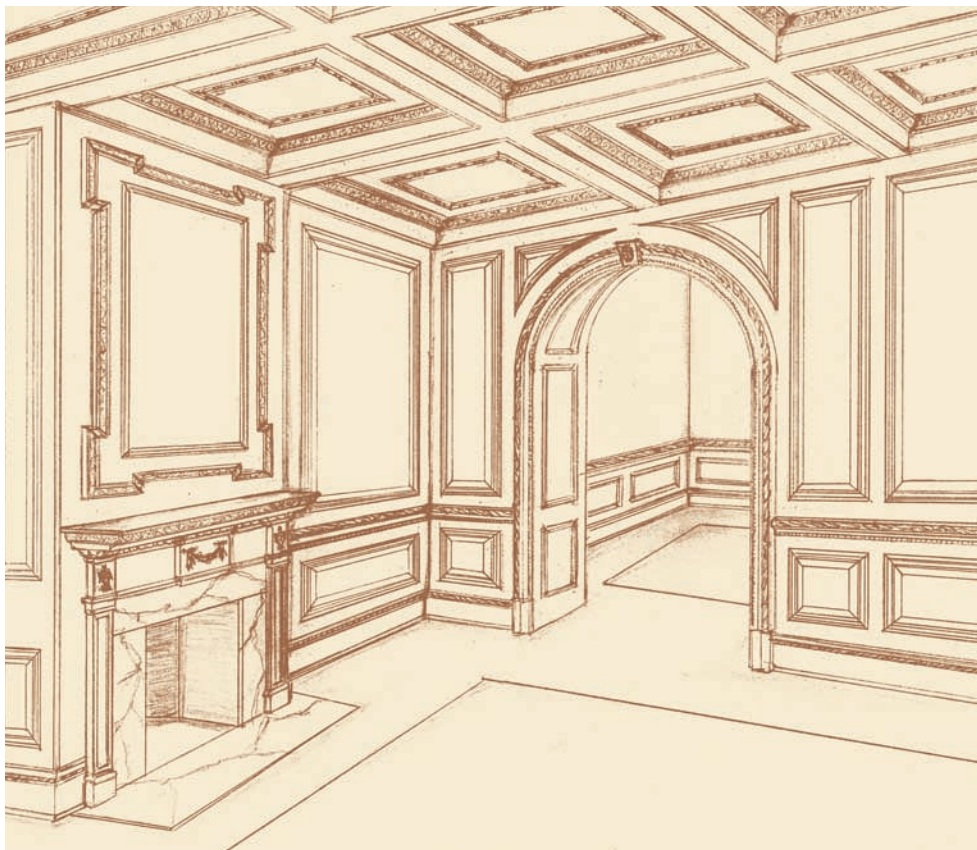
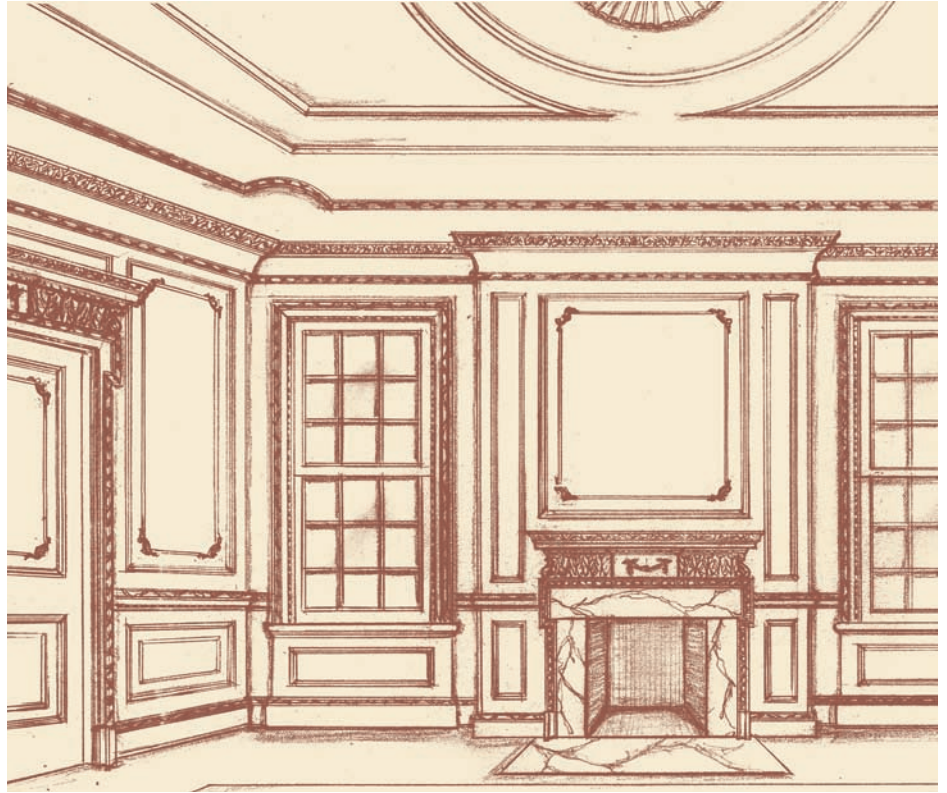

Reflecting colonial style, this appealing space combines wall paneling and an arched doorway accented with a stately coffered ceiling. The wall panels include a smooth panel mould, while the chair rail and casing are decorated with a running leaf and bead pattern. A simple swag with urns adorns the mantel and is applied below the acanthus leaf cornice moulding.

BEAMS	MANTEL
PM8529	Above Mantel
CM8810	BB8108
B403	DS1x8
CHAIR RAIL	PM582
CA8320	MANTEL
WALL PANELS	CM8810
PM500	DS1x4
DOOR CASING	PM8535
KEY034	DS1x8
CA8320	CRV5063
BASEBOARD	CRV5072
PM8546	PM535
DS1x6	PM580
QR105	DS1x6

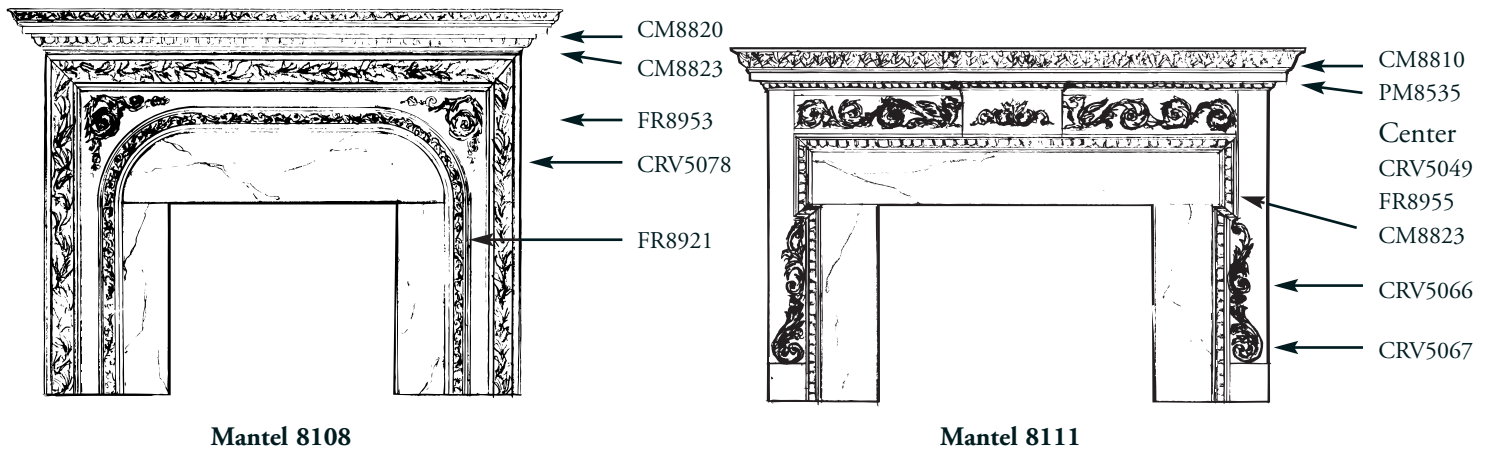
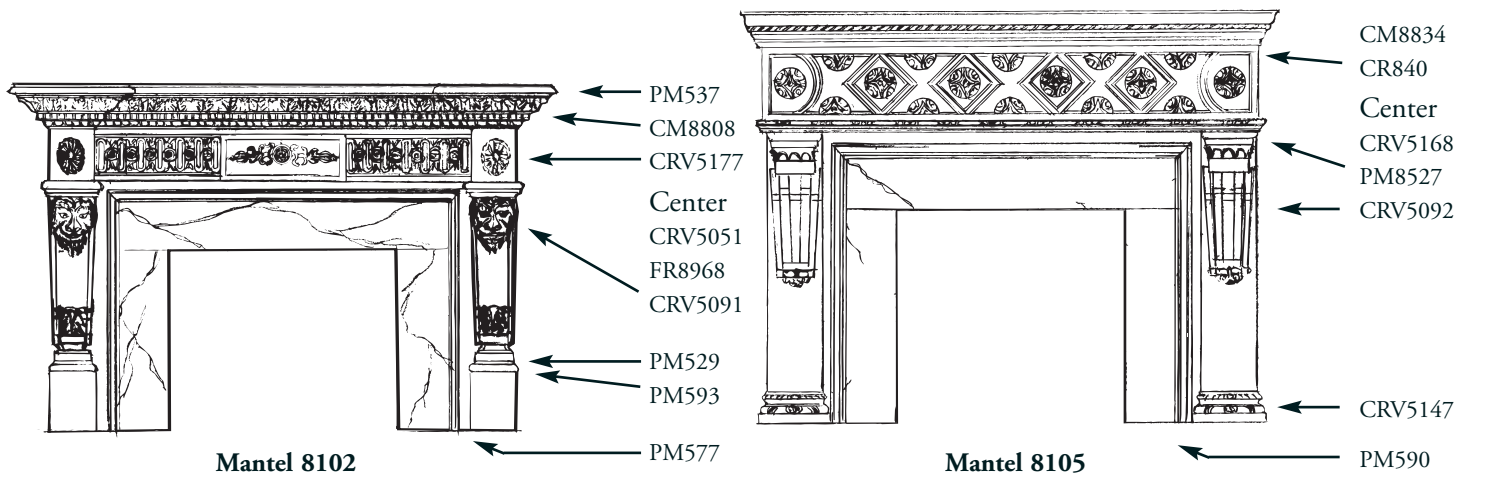

*These exceptional mantel styles show amazing versatility using
 White River's™ Mon Reale® & Authentic Hand-Carved®.
 These are offered as concepts only to be jobsite built to your specifications.
 Order mouldings and carvings individually.*

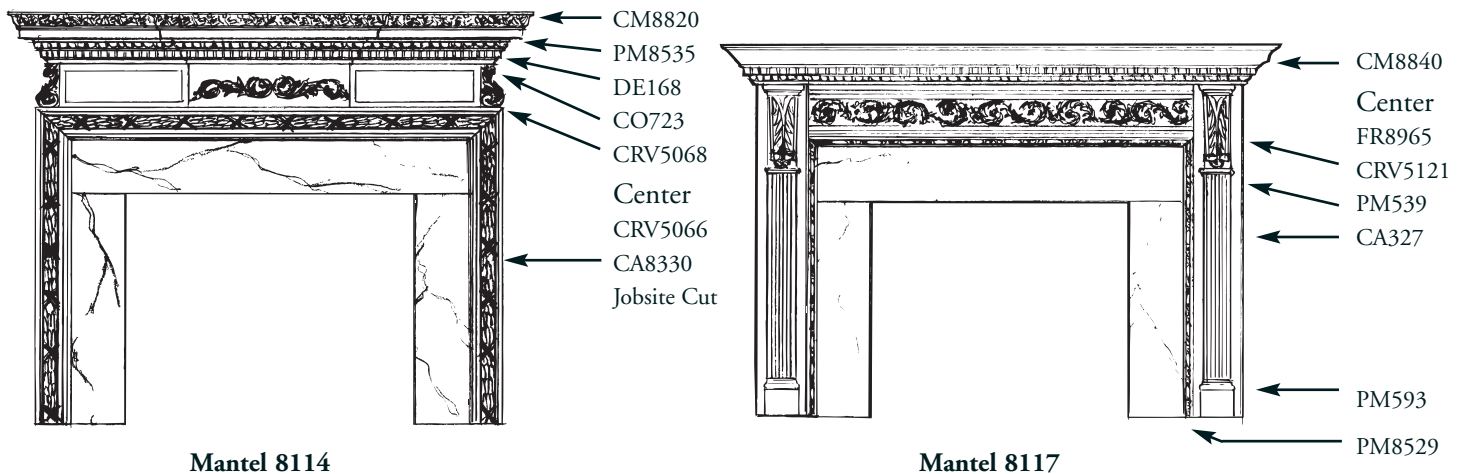

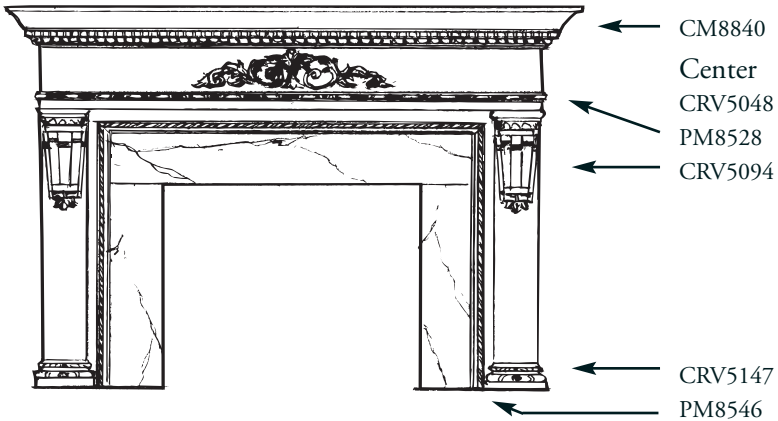

Mantel 8120

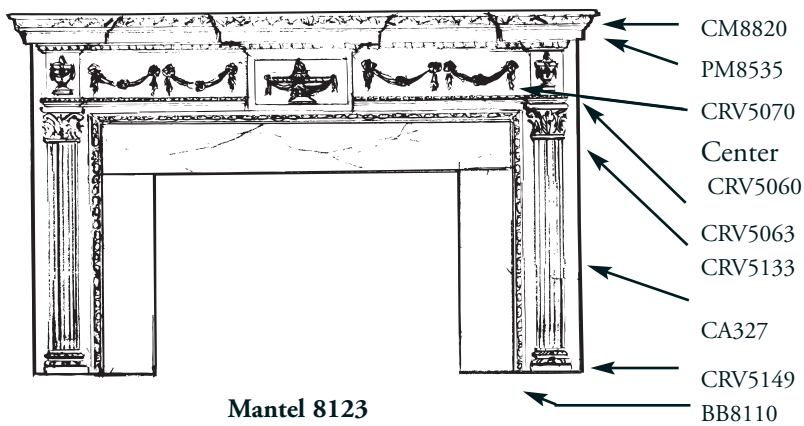

Mantel 8123

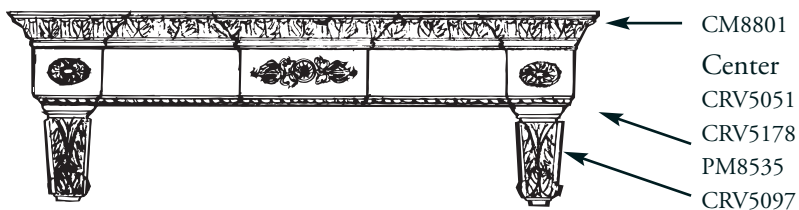

Mantel 8126

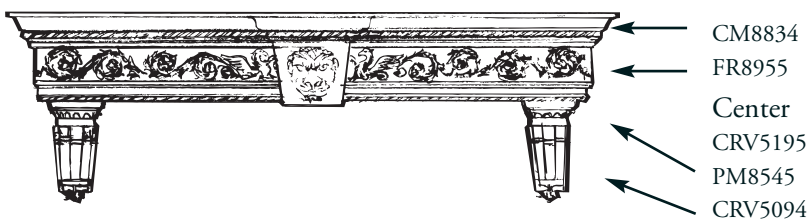

Mantel 8129

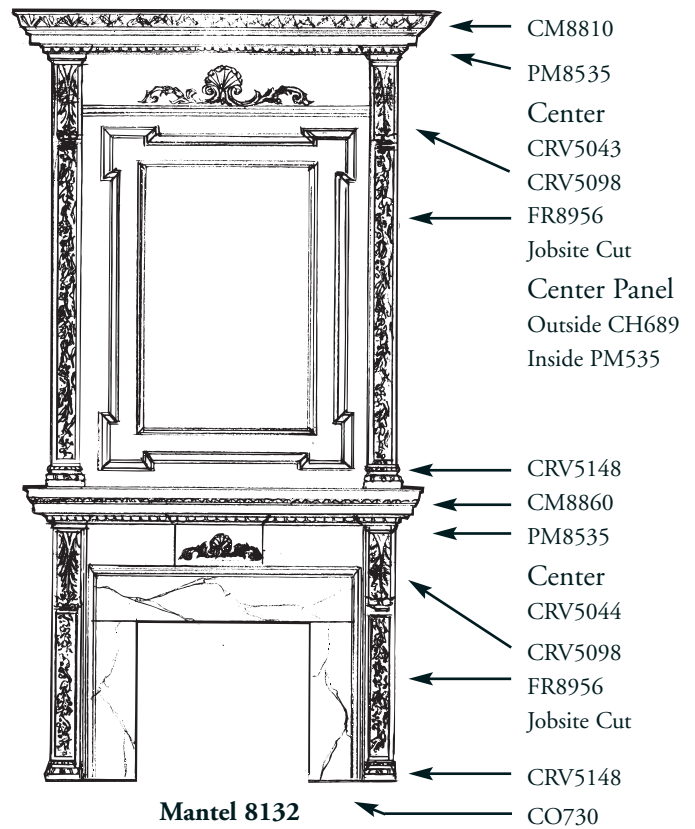

Mantel 8132

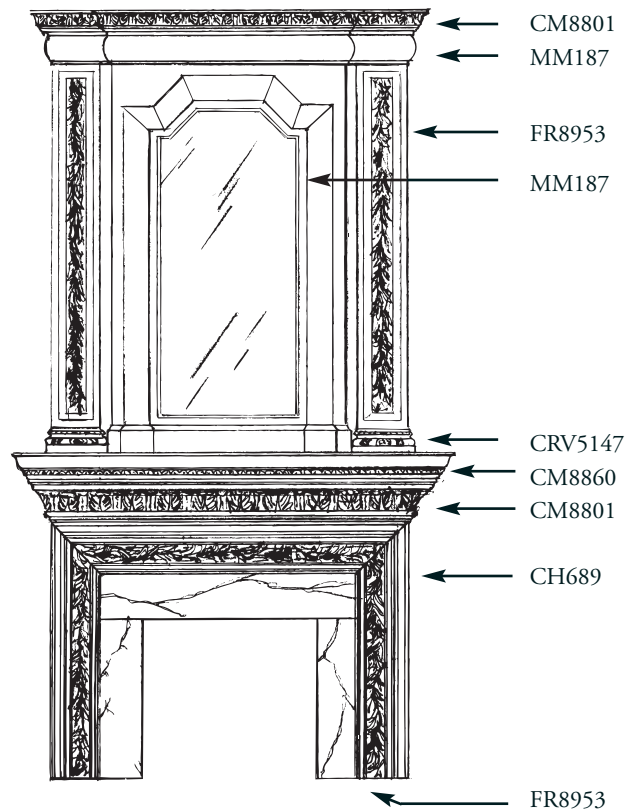

Mantel 8135

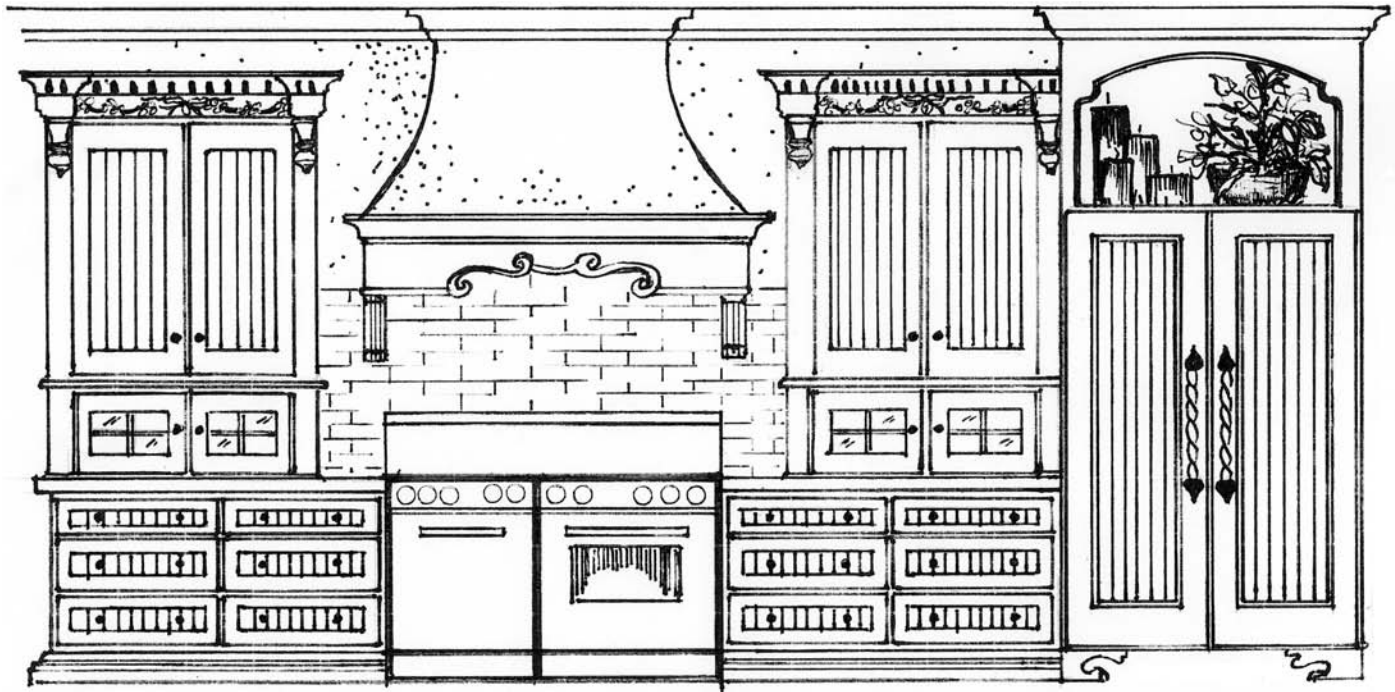

TRADITIONAL AMERICANA - MLD5860, MLD5900, CRV5520, CRV5514, CRV5546, RH6080, CRV5256, FT6272

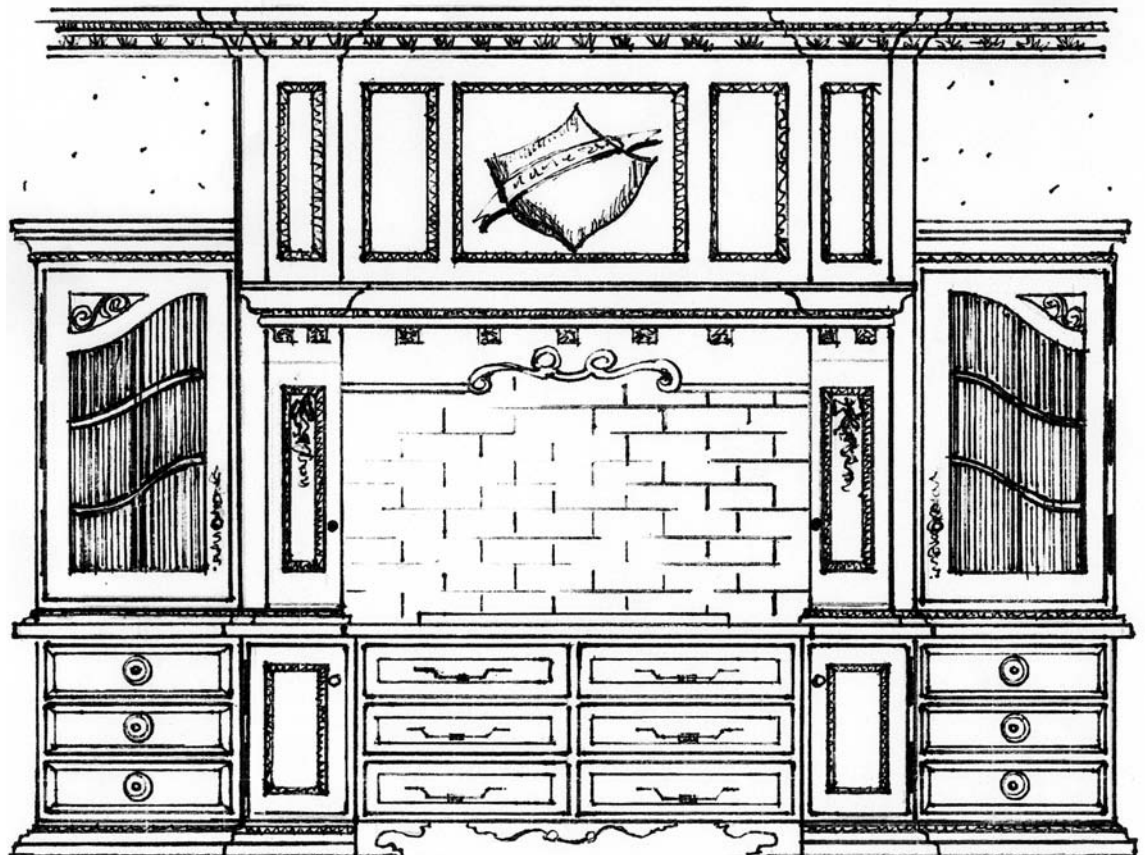

FRENCH COUNTRY
MLD5848, MLD5940,
MLD5968, MLD5986,
CRV5123, RH6080,
CRV5087, MLD5976,
CRV5614, MLD5976,
FT6272, FT6474

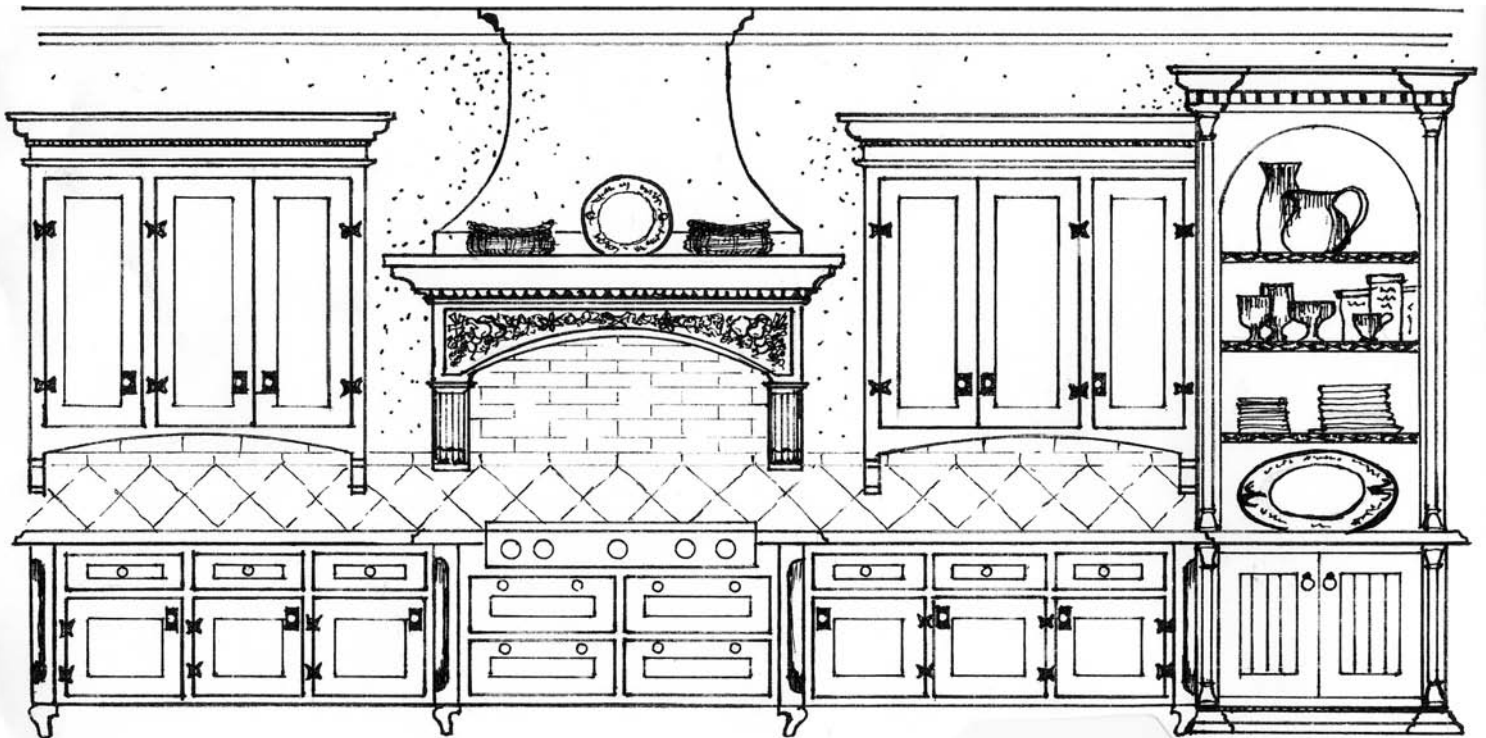

AMERICAN CHARM - MLD5982, MLD5848, MLD6024, CRV5512, MLD5820, MLD5948, RH6075, MLD5976, CRV5253, CRV5624, CP6250, FT6266

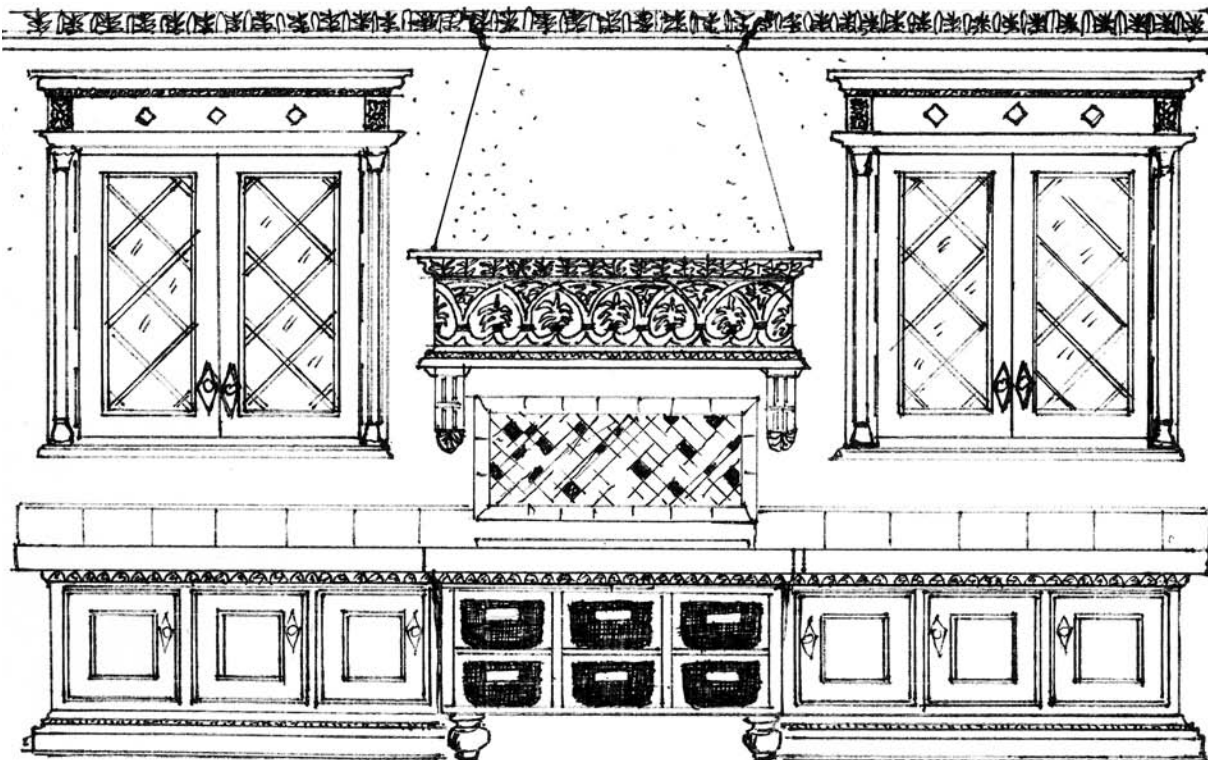

MOROCCAN
MLD5840
MLD5848
CRV5173
CRV5586
CRV5516
MLD5824
MLD5978
MLD5842
MLD5976
RH6084
CRV5092
MLD5958
FT6294

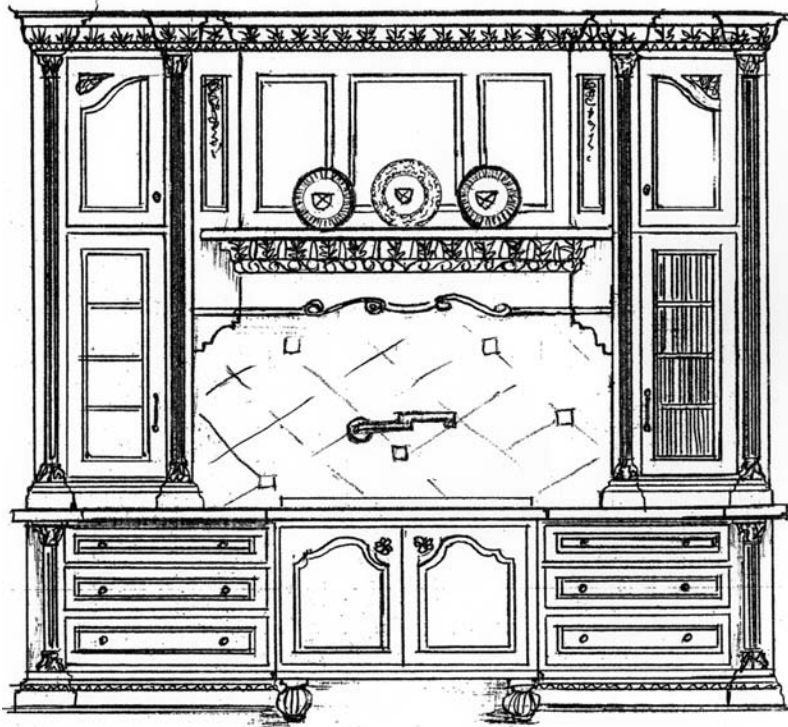

FRENCH ESTATE RANGE -
MLD5866, MLD6002, MLD5840,
CRV5087, CRV5634, CRV5502,
MLD5812, MLD5944, RH6080,
CRV5624, FT6290, MLD5970

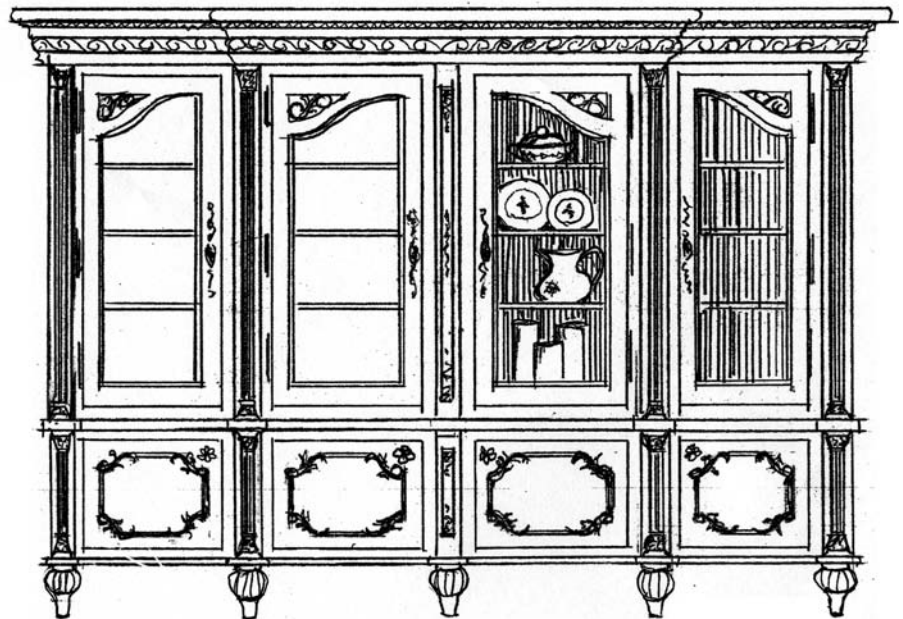

FRENCH ESTATE ARMOIRE -
MLD5864, MLD6002, MLD5944,
CRV5502, MLD5812, CRV5636,
CRV5634, CRV5079, MLD5616,
CRV5638, FT6290

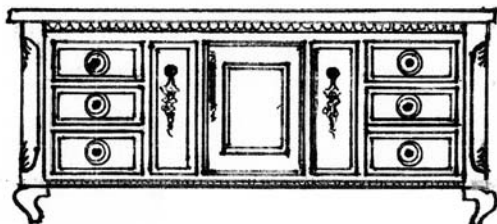

FRENCH COUNTRY ESTATE ISLAND - MLD5978,
MLD5976, CP6244, CRV5614, CRV5614, FT6266

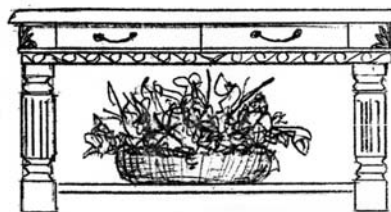

FRENCH ESTATE ISLAND - CRV5576,
MLD5944, CML6212

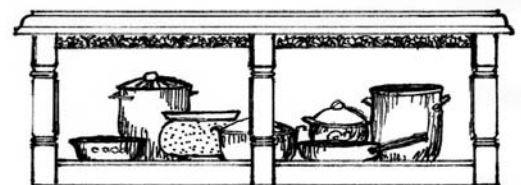

AMERICAN CHARM ISLAND
MLD5926, CML6214

ROYAL VANITY -
CRV5604, CRV5043, CRV5191,
PM8569, CRV5614, CRV5618,
MLD5964, MLD5840, MLD6028,
CRV5173, MLD6020, CRV5644,
CRV5256, CRV5079, MLD5814,
PM485, CRV5510, FT6290,
CRV5093, MLD5903

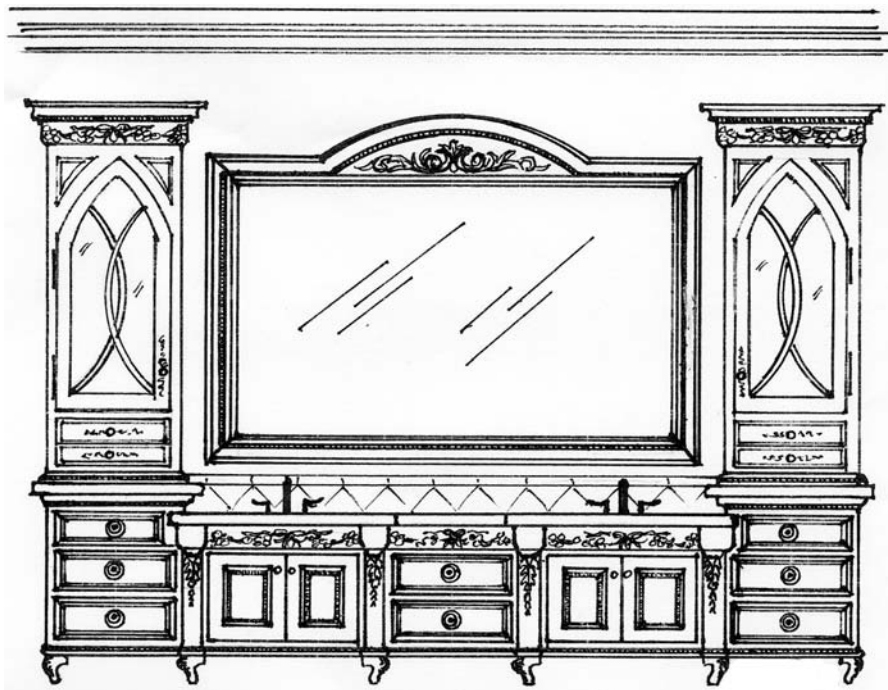
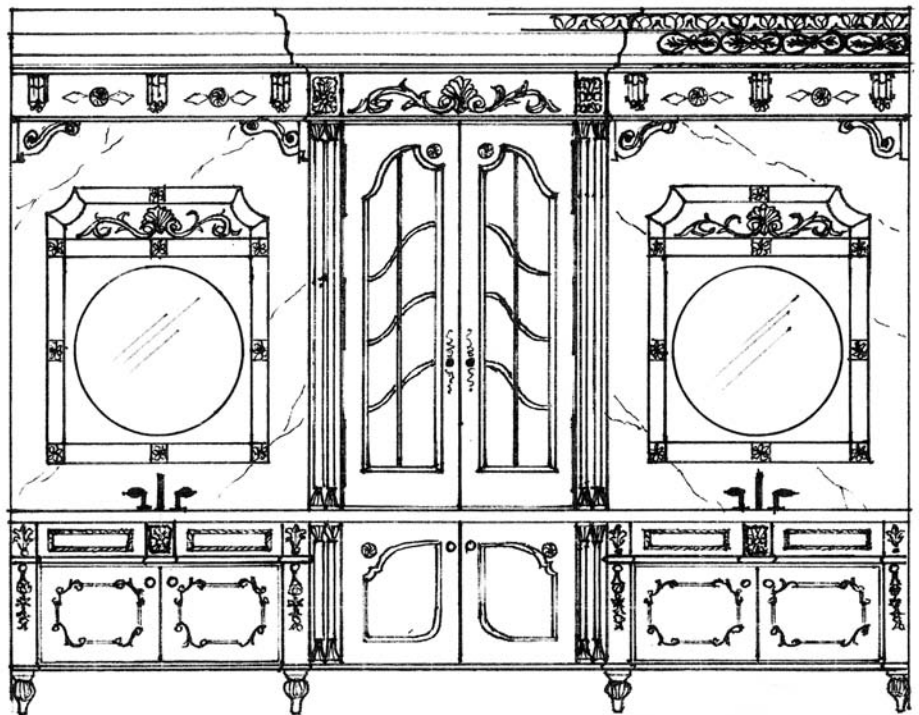

FEMININE VANITY -
MLD5866, MLD6002,
MLD5840, PM511,
CRV5046, MLD5970,
MLD5900, FT6262,
CRV5634, CRV5640,
CRV5614

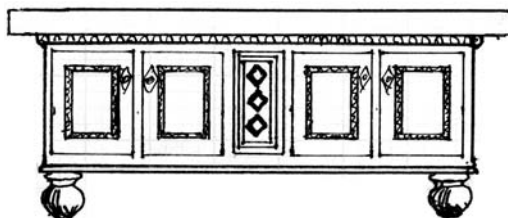

MOROCCAN ISLAND
MLD5958, MLD5968, CRV5584, FT6294

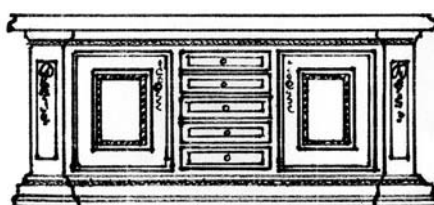

ENGLISH ESTATE - MLD5978, CRV5636,
MLD5979, MLD5972

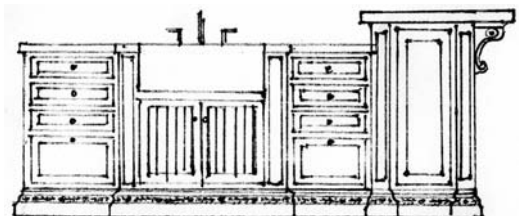

TRADITIONAL AMERICANA
CRV5256, MLD5928

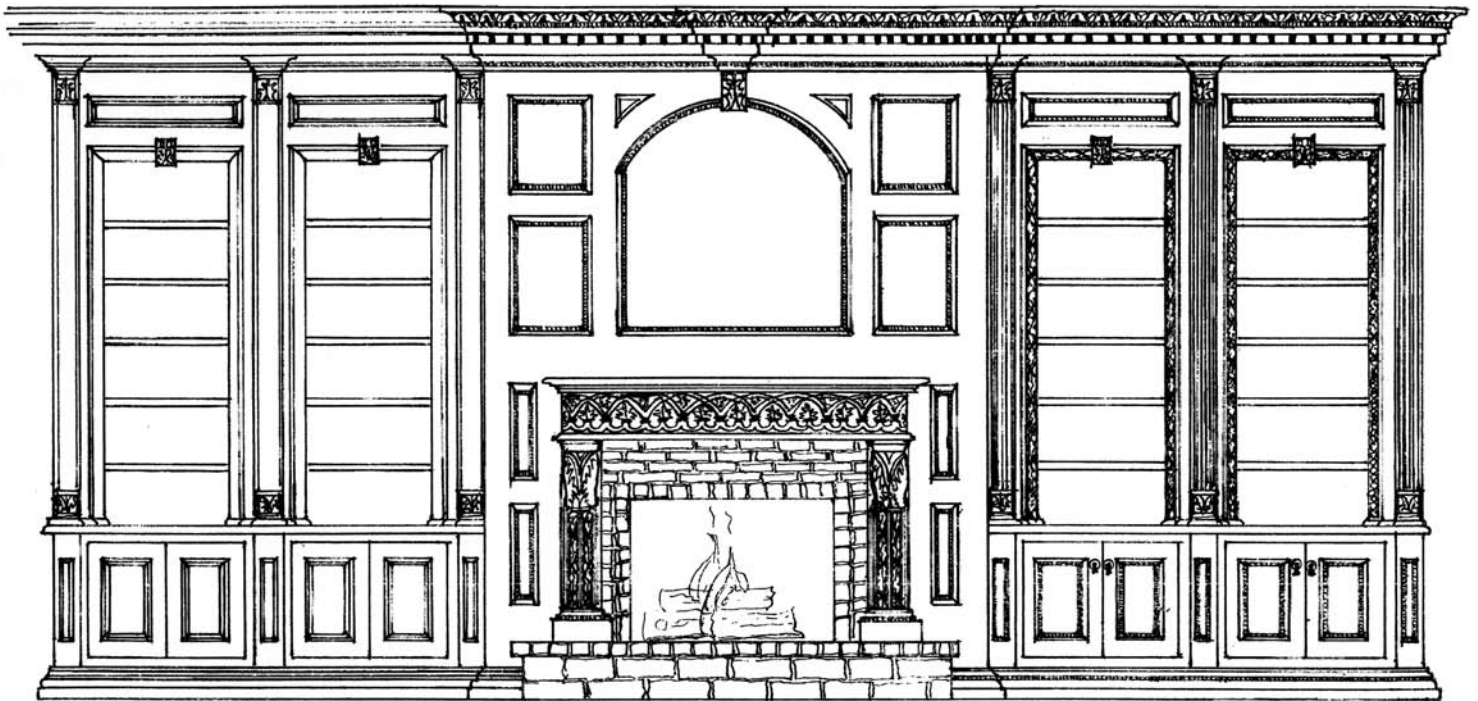

FORMAL LIBRARY - CRV5568, MLD5962, MLD5840, MLD5830, MLD5982, MLD5980, DS1 x 2, PM590, PM526, MLD5970, PM529, CRV5580, MAN9035, CRV5576, CRV5097, CRV5570, MLD5922

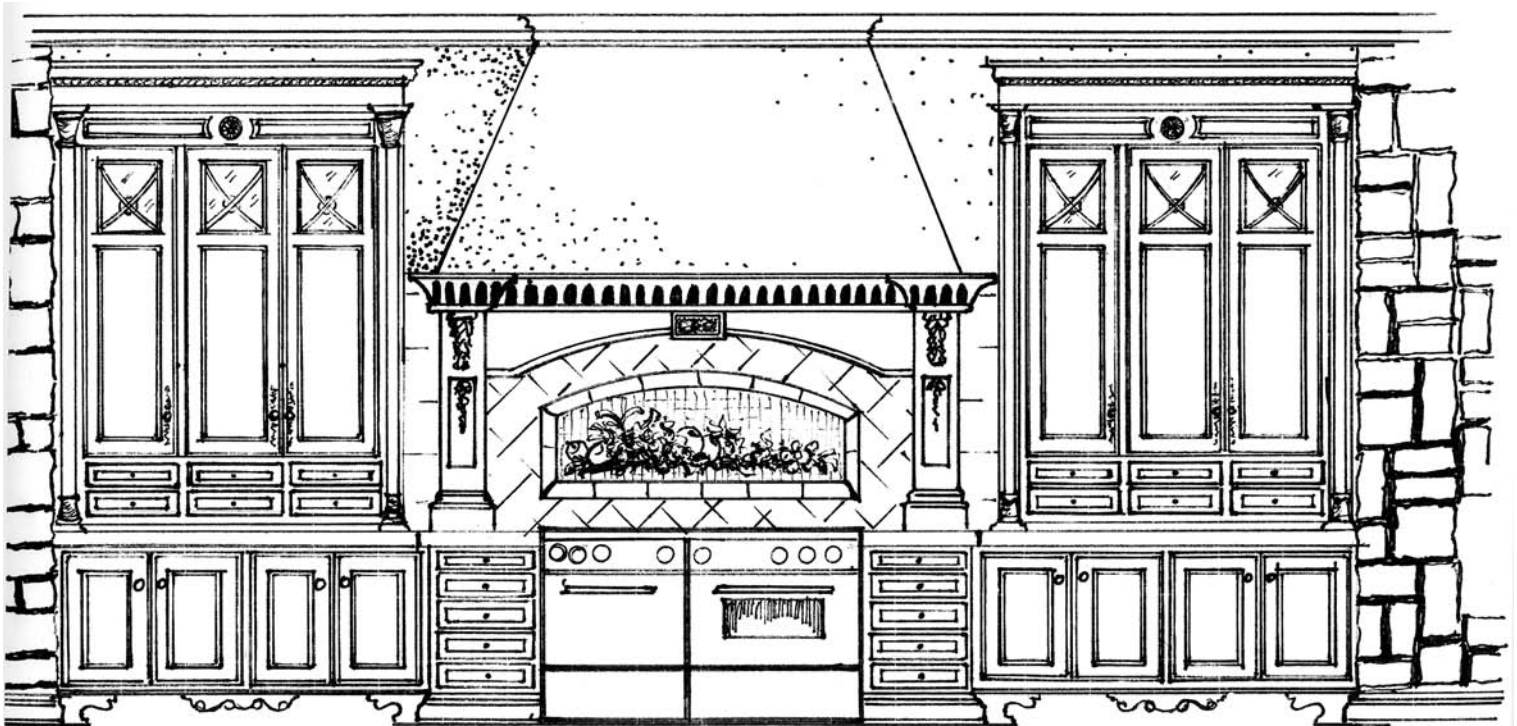

ENGLISH COUNTRY ESTATE - MLD5868, MLD5864, MLD5950, CRV5614, CRV5620, CRV5616, CRV5512, CRV5820, RH6075, CRV5172, MLD5860, CRV5121, CRV5636, FT6272, FT6274

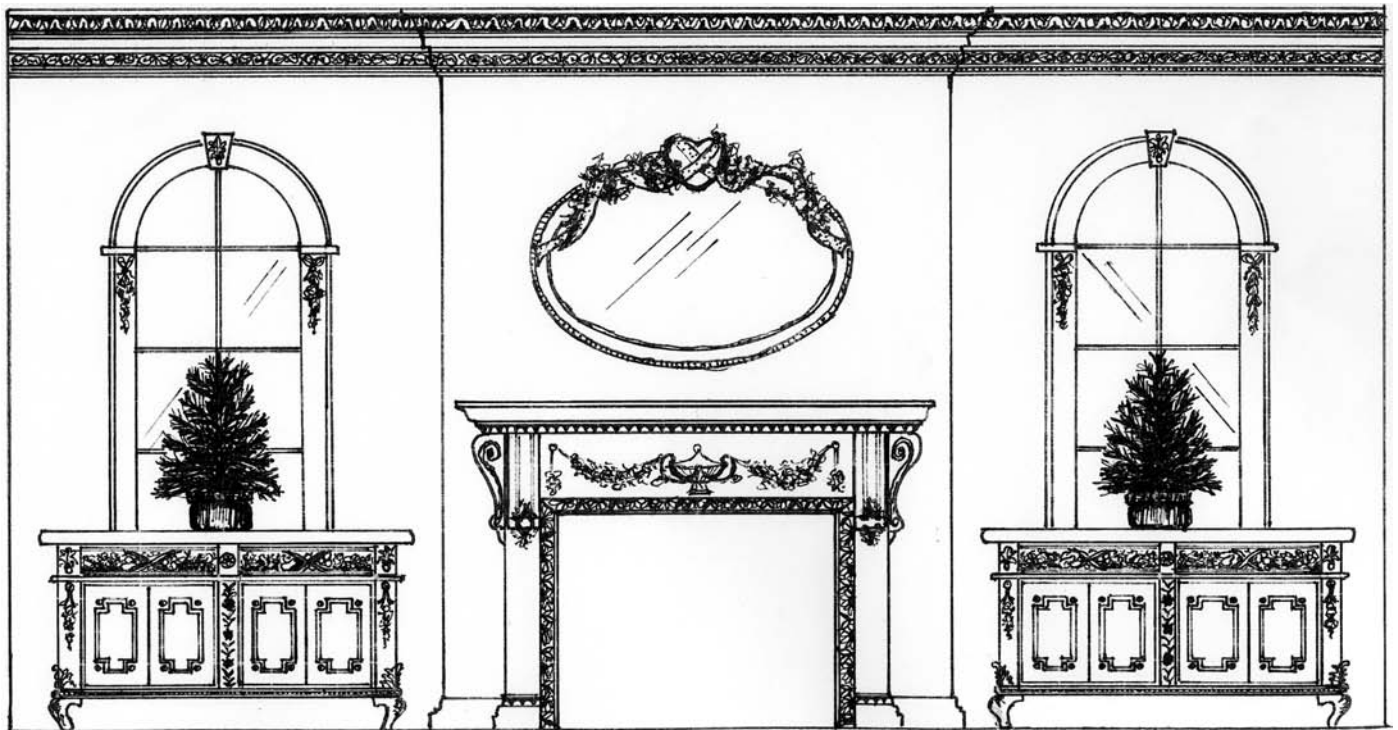

FORMAL MANTEL SETTING - MAN9012, CRV5093, MLD5840, CRV5576, CRV5620, MLD5970, MLD5928, CRV5642, MLD6028, CRV5087, MLD5964, MLD5902, FT6262, CRV5644, MLD5903, CRV5071

ENGLISH TUDOR -

MLD5848,
MLD5902,
RH6078,
RH6075,
CRV5230,
CRV5620,
MLD5968,
CRV5614,
MLD6020,
CRV5228

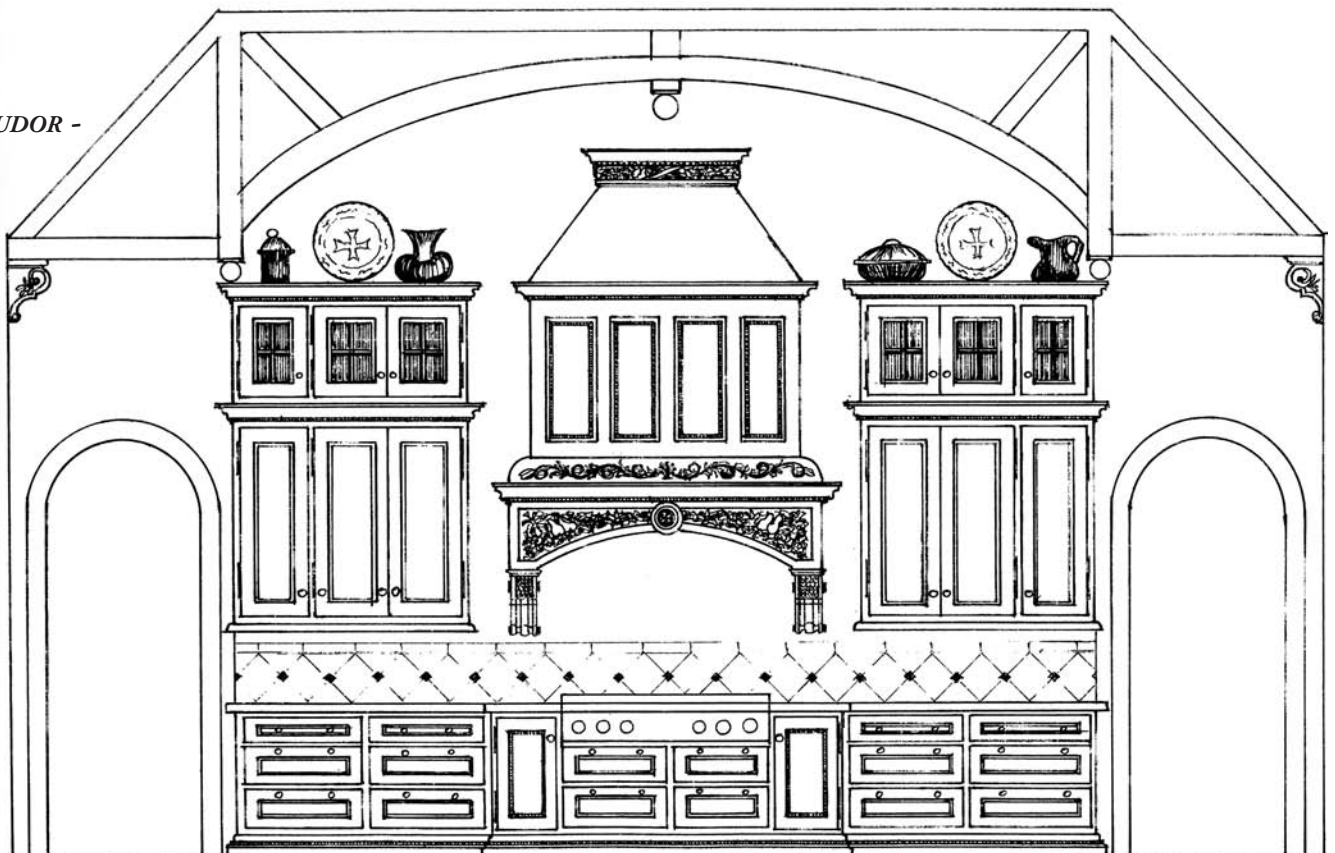

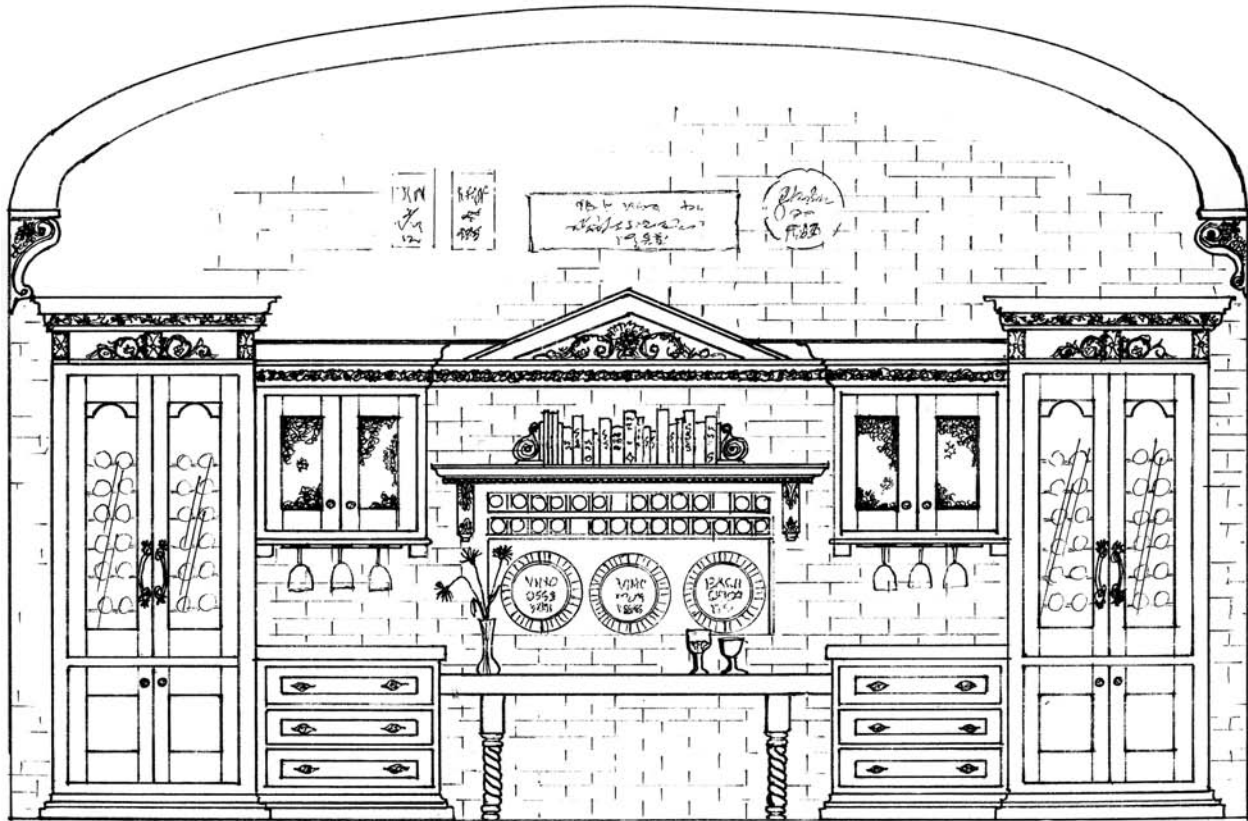

VINEYARD SERIES WINE CELLAR - CRV5110, CRV5100, MLD5916, CRV5626, CRV5173, CRV5032, CRV5024, CRV5036, CRV5030, CRV5034, CRV5020, CML6210, MLD5848, MLD5968, CRV5259

RUSTIC MANTEL SETTING -
MAN9012,
MLD5848,
CRV5582,
MLD5832

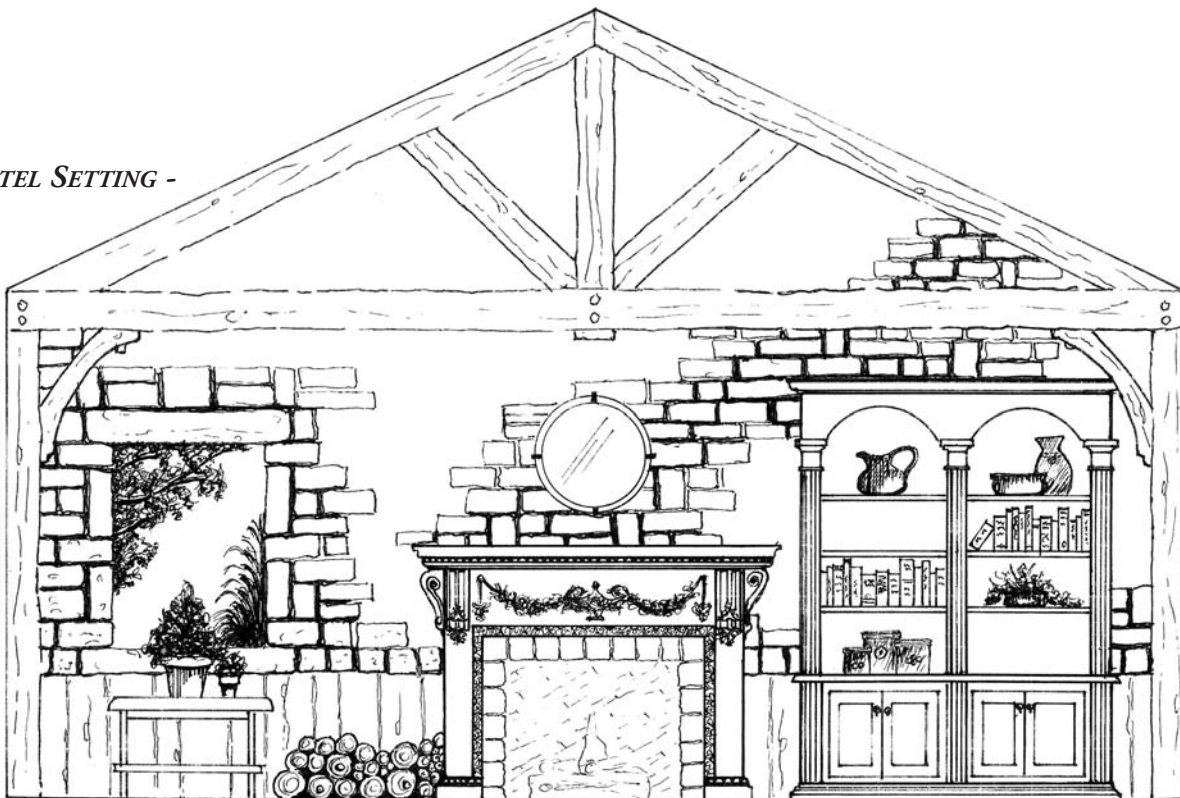

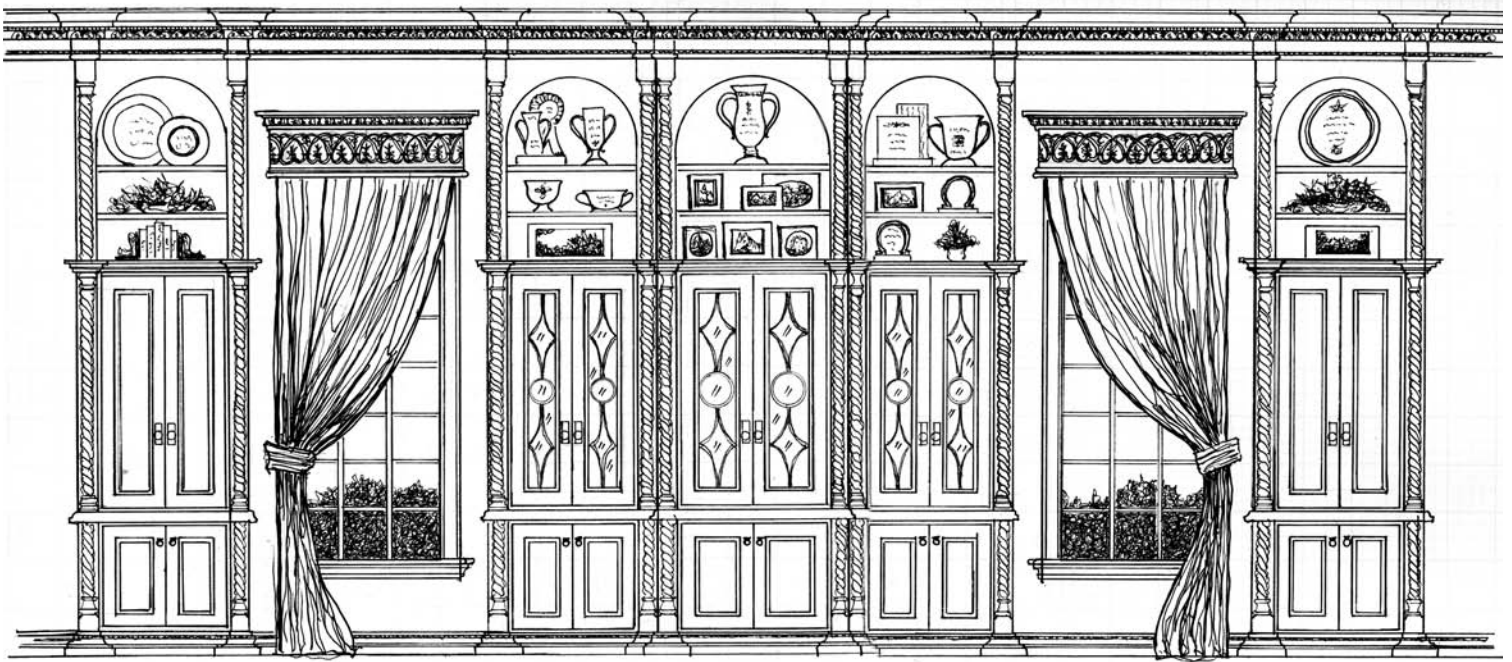

Trophy Room - RH6084, PM590, MLD5975 w/ MLD6002, MLD5840, MLD5982, MLD5864, MLD5800, MLD5842, CRV5518, CRV5512

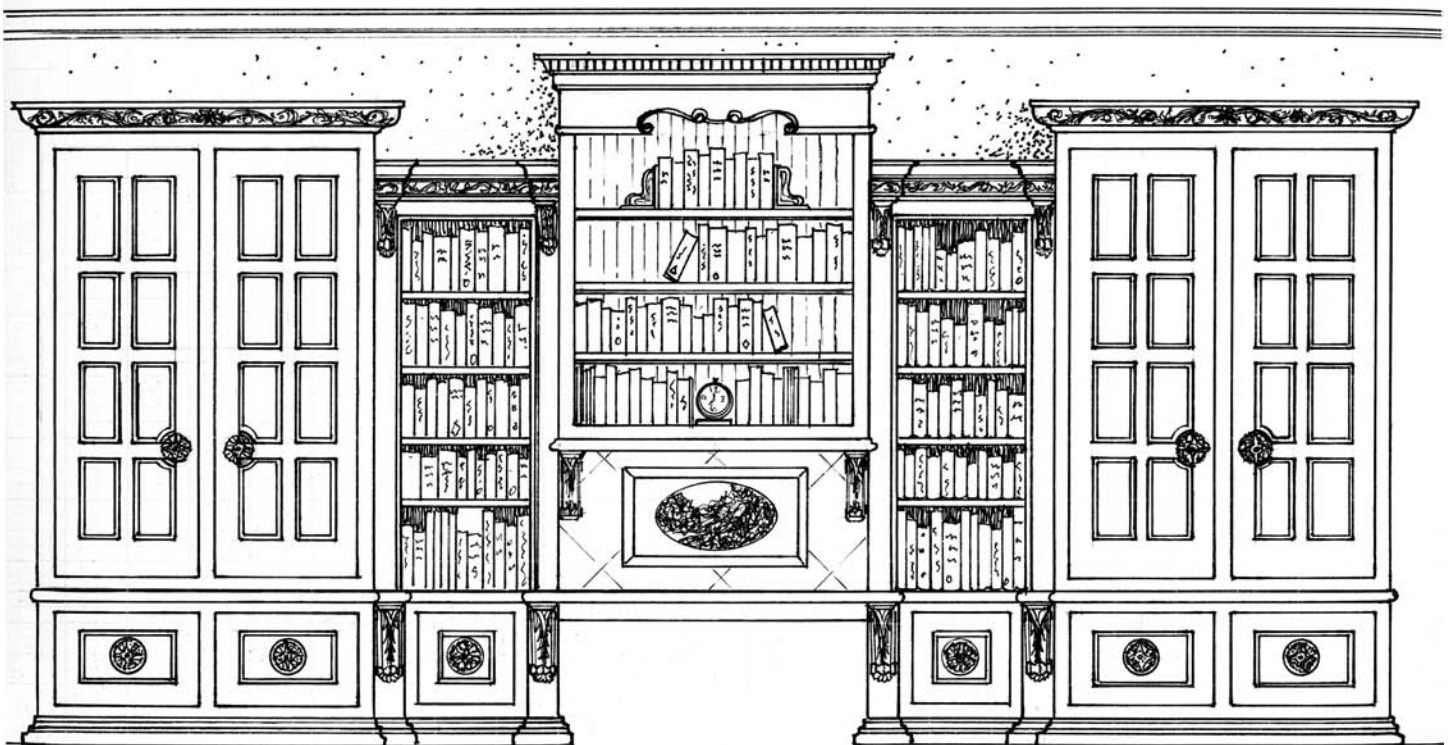

Working Library - RH6078, RH6080, MLD5860, MLD5914, MLD5864, MLD6002, PM590, CRV5121, CRV5590, CRV5120